



**Gourmia**

# **Formula Maker**

Model# JFM-200

**USER MANUAL**

Read this manual thoroughly  
before using and save it for  
future reference

FOR CUSTOMER SERVICE  
QUESTIONS OR COMMENTS  
VISIT US @ GOURMIA.COM  
INFO@GOURMIA.COM  
OR CALL 888.552.0033

**Visit [GourmiaJr.com](http://GourmiaJr.com) for important product information and  
regularly updated manuals**

Model: JFM-200  
© 2018 Gourmia  
[www.gourmia.com](http://www.gourmia.com)  
The Steelstone Group  
Brooklyn, NY

All rights reserved. No portion of this manual may be reproduced by any means whatsoever without written permission from The Steelstone Group, except for the inclusion of quotations in a media review.

Although every precaution has been taken in the preparation of this manual, The Steelstone Group assumes no responsibility for errors or omissions. Nor is any liability assumed for damages resulting from the use of the information contained herein. Although every effort has been made to ensure that the information contained in this manual is complete and accurate, The Steelstone Group is not engaged in rendering professional advice or services to the individual consumer; further, The Steelstone Group shall not be held responsible for any loss or damage allegedly arising from any information or suggestion in this manual.

# **Welcome to the Convenient World of** *Formula Making* **from Gourmia**

Thank you for purchasing a Gourmia Formula Maker!

The pages of this manual offer comprehensive instructions to guide you through the functions and features of the Gourmia Formula Maker. Inside this guide you will also find information on its modes of operation, complete step-by-step instructions for the operation, assembly, cleaning, and maintenance of your appliance.

Please read all safety instructions thoroughly to ensure safe usage at all times.

Thank you for your purchase. We sincerely hope you will enjoy this as well as all the many innovative products brought to you by Gourmia.

## IMPORTANT SAFEGUARDS

*Before using this product please read this manual carefully, and save for future reference.*

**ALWAYS TEST THE MILK TEMPERATURE BEFORE FEEDING YOUR BABY.**

### SAFETY INSTRUCTIONS

*When using any electric appliance, basic precautions should always be followed to reduce the risk of fire, electric shock and injury, including the following:*

1. Read all instructions.
2. To protect against electrical shock do not immerse cord, plugs, or the base of the machine in water or other liquids.
3. Close supervision is necessary when any appliance is used by or near children.
4. Do not operate any appliance with a damaged cord or plug or after the appliance malfunctions or has been damaged in any manner. Return appliance to the nearest authorized service facility for examination, repair, or adjustment.
5. The use of accessory attachments not recommended by the appliance manufacturer may cause injuries.
6. Do not use outdoors.
7. Do not let cord hang over edge of table or counter, or touch hot surfaces.
8. Do not place on or near a hot gas or electric burner, or in a heated oven.
9. Always attach plug to appliance first, then plug cord into the wall outlet. To disconnect, turn any control to "off", then remove plug from wall outlet.
10. Do not use appliance for other than intended use.
11. Before serving be sure food is at safe temperature.
12. This appliance is for adult use only. Persons under the age of 13 should not use this product.
13. Do not exceed the maximum level of water- the appliance will not work.
14. Always place the formula maker on a dry, flat surface- out of reach of children.
15. Always check the concentration chart when using a formula for the first time.
16. To ensure accurate dispensing, follow recommended cleaning and maintenance procedures.

#### **Electromagnetic field (EMF)**

**This appliance complies with all standards relating to electromagnetic fields (EMFs). It meets the safety rules established on the basis of current scientific knowledge provided it is handled correctly and in compliance with these instructions.**

# TABLE OF CONTENTS

<b>Know Your Formula Maker .....</b>	<b>6</b>
<b>Formula Maker Assembly .....</b>	<b>8</b>
<b>Using Your Formula Maker.....</b>	<b>11</b>
<b>Cleaning and Maintenance .....</b>	<b>15</b>
<b>Troubleshooting and FAQs.....</b>	<b>16</b>
<b>Tips .....</b>	<b>17</b>



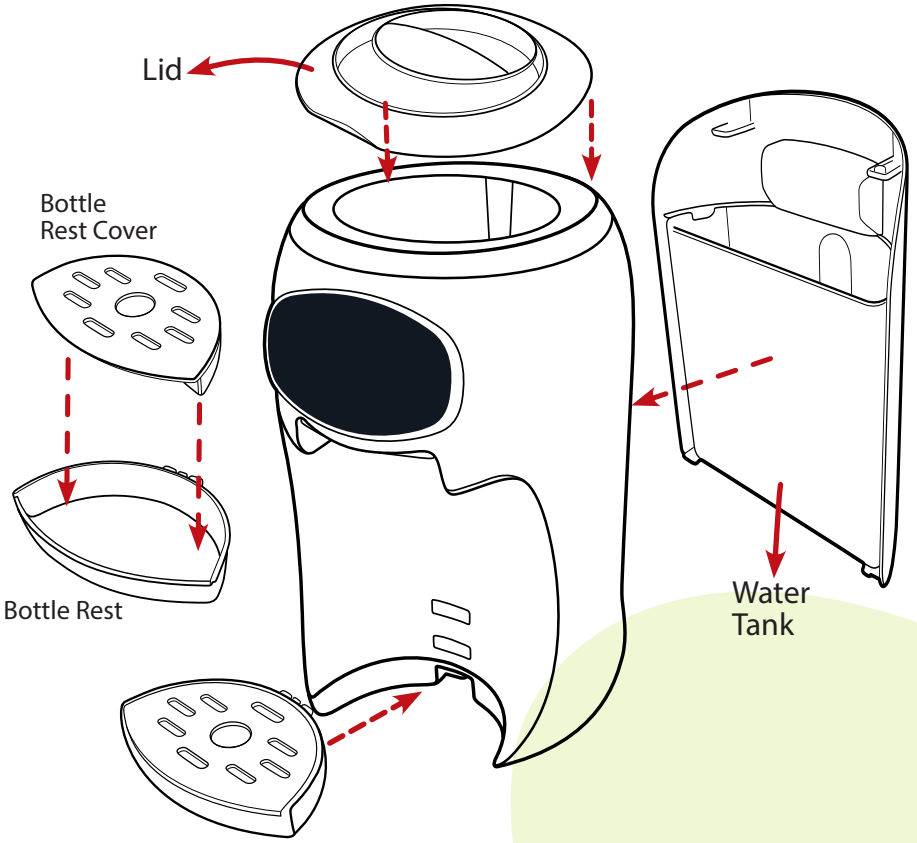

### Powder Bin Assembly

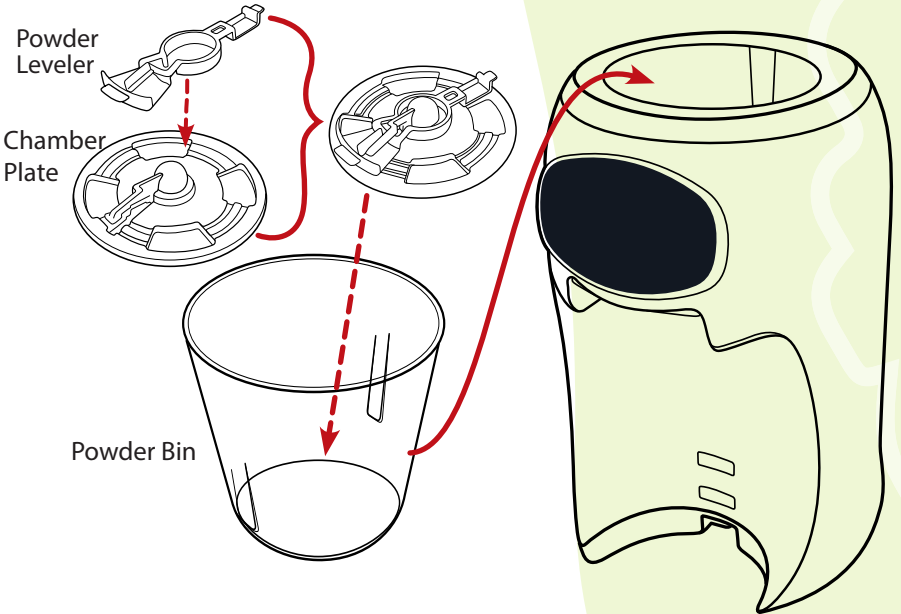

## Powder Bin Assembly

*Before assembly, wash and completely dry the powder bin, leveler, and the chamber plate.*

1. Line up the powder leveler and chamber plate as shown.

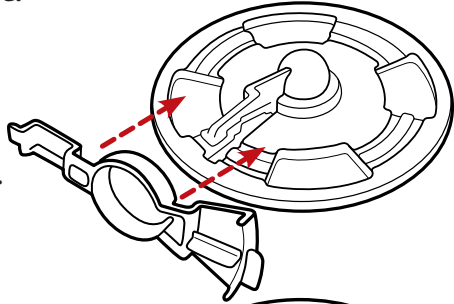

2. Slide it in.

3. Rotate the chamber plate as shown below.

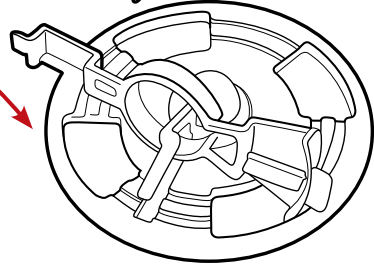

4. Insert both components into the powder bin. Align the tabs of the powder leveler as shown below.

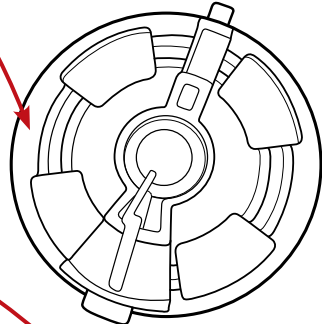

5. Place the powder bin into the base, aligning the slots to those of the shaft.

6. Press down on the powder bin lightly and turn the chamber plate until it locks to the cross on the base shaft. You will feel everything drop into place.

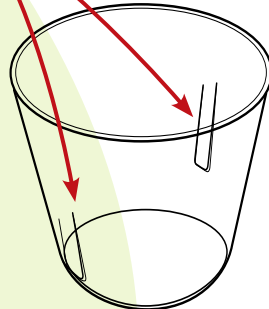

*Always keep the powder bin covered. When exposed to the air, formula may become stale or moist. This may affect proper powder dispensing.*

## Funnel Assembly

1. Press the funnel lid into the funnel as shown in the image below. Make sure that you align the funnel slots correctly to ensure a secure fit.
2. Slide the funnel into the formula maker. Keep it horizontal and press upwards while pushing the funnel in. Press firmly until it is secure, but not too hard.

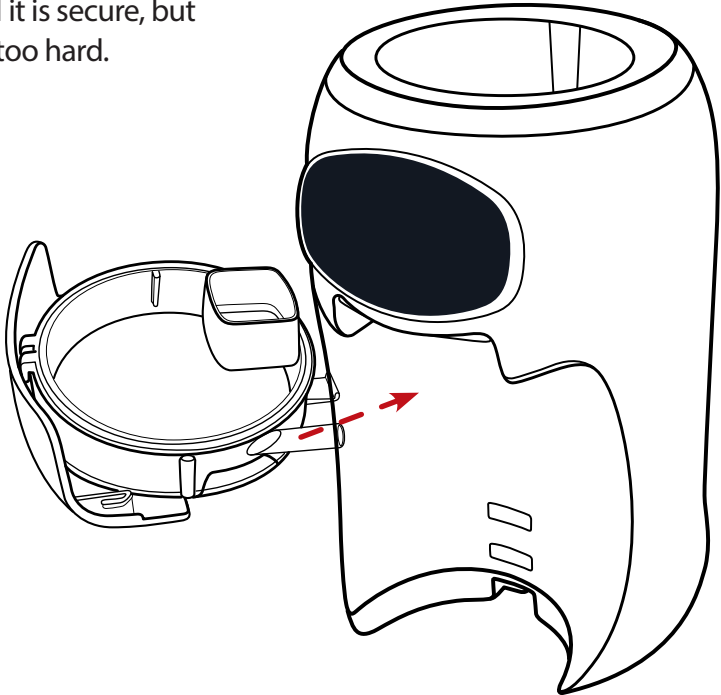
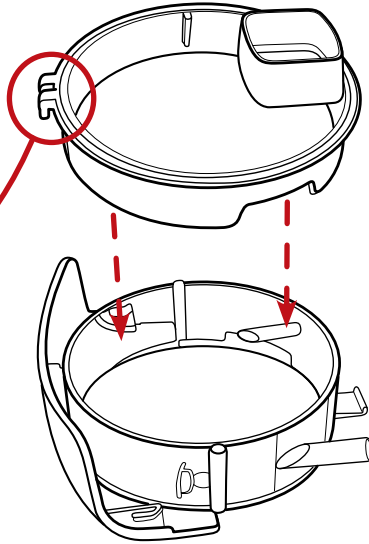



## Installing the Water Tank

1. Fill the water tank to "Max" line inside.  
Place the water tank behind the formula maker.

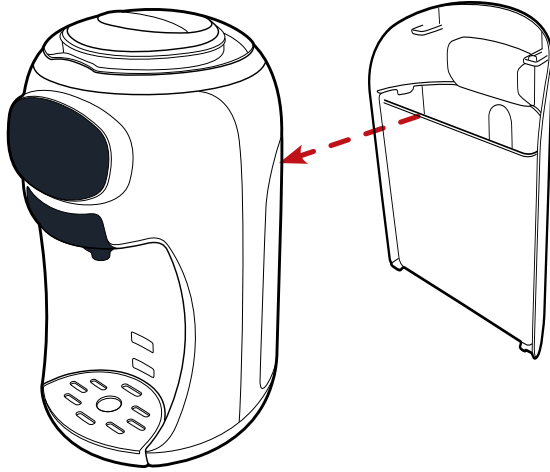

## Installing the Bottle Rest

1. Place the bottle rest cover on the bottle rest.
2. Choose an appropriate height slot for your bottle. Use a lower setting for tall bottles and a higher setting for short bottles.
3. Insert the bottle rest into the slot of your choice.
4. Be sure to clean the bottle rest and cover if there is ever a spill.

Bottle Rest Cover

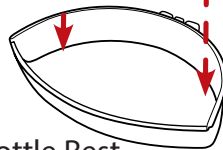
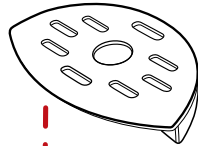

Bottle Rest

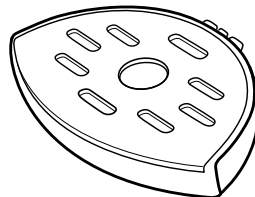

COMBINED

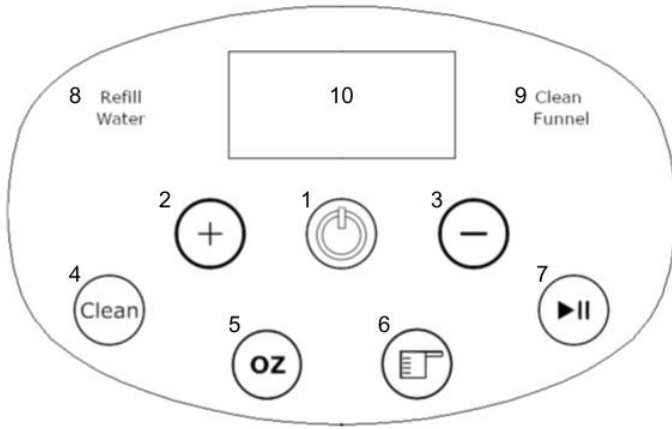

## DISPLAY

### Buttons and Indicators

1. Power Button
2. Increase Setting
3. Decrease Setting
4. Clean
5. Set Water Volume
6. Set Formula Concentration
7. Play/Pause Dispensing
8. Refill Water Indicator
9. Clean Funnel Indicator

## First Use

1. Please ensure that the machine is fully assembled and that the parts have been cleaned.

***After washing parts, it is crucial that all components are thoroughly dried.***

2. Fill water tank.
3. Plug in the machine and press the power button to turn it on.
4. The unit must take in water for the first time and flush itself.
  - a. In order to do this, place a container or bottle beneath the funnel.
  - b. Press the "Clean" button and wait for the water to be released.
  - c. Dump the water.
5. Once that is finished, you can now use your machine!

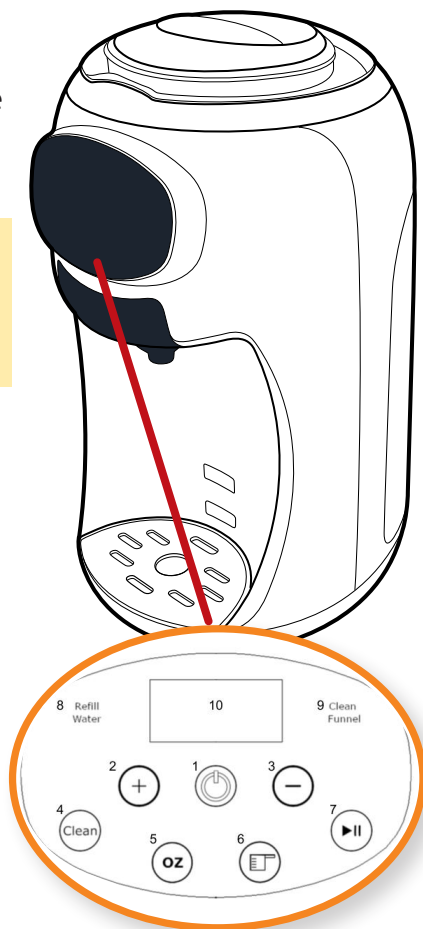

## BEFORE USING YOUR FORMULA MAKER

*Always ensure that the powder bin is more than ¼ full before use.*

*If this is your first time using the product, please see the instructions above in “First Use”.*

1. After the initial setup, you must determine the correct concentration setting for your formula. Every formula brand recommends a different amount of powder per ounce.
2. Check your formula to see the **weight (in grams)** required per **2 fl oz** of water.
3. See the table below to find your setting. If your number is between two values on the left column, round up.

**The chart below provides approximate values. Please visit [GourmiaJr.com/formulasetting](http://GourmiaJr.com/formulasetting) for an easier-to-use, up-to-date list.**

4. If your required powder amount is above or below the range of the chart, the formula is not compatible with this product.

Powder Required per 2 fl oz (60 ml)	Concentration Setting	Water Volumes Available
Close to 4.4g	1	2 - 4 oz (60 - 120ml)
Close to 6.9g	2	2-10 oz (60- 300ml)
Close to 8.4g	3	2-10 oz (60- 300ml)
Close to 8.9g	4	2-10 oz (60- 300ml)
Close to 9.6g	5	2-10 oz (60- 300ml)
Close to 10.1g	6	2-10 oz (60- 300ml)

For a list of recommended formulas and their formula settings, please visit [GourmiaJr.com/formulasetting](http://GourmiaJr.com/formulasetting)

***Do not use a lower concentration setting to save formula. Using a setting that is too low can cause health issues.***



1. Once you know your concentration setting, press the scoop button and use the + and - buttons to choose the correct setting.
2. Press the scoop button again to confirm.



3. Press the OZ button to select the amount of formula you would like (Remember, this setting is the amount of water that goes with your formula, so the final mix will appear to be a bit more than selected).



4. Press the OZ button again to confirm.



5. Once you have set your volume and concentration, press the start/pause button to begin releasing formula.

## CLEANING AND MAINTENANCE

*To ensure proper powder release amounts, the unit must be cleaned and maintained according to the instructions below.*

1. After every four uses, the funnel must be removed and rinsed, and the powder release opening must be wiped thoroughly with a dry cloth to prevent powder buildup.

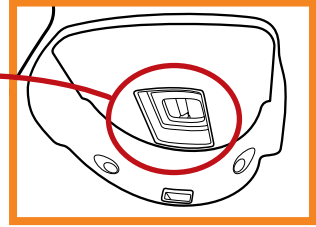

**BOTTOM VIEW**  
(Behind Funnel)

2. If the machine is not going to be used for an extended period of time, please empty the contents of the water and powder bin and press the "Clean" button to release all of the water from inside.

Note: Replace the water in the tank at least once a day

3. Also, if you will not use the machine for an extended period of time, clean around the powder release opening to avoid powder buildup and hardening.

4. Keep the machine clean and dust free.
5. Some parts, including the powder leveller, are delicate. Please handle with care.

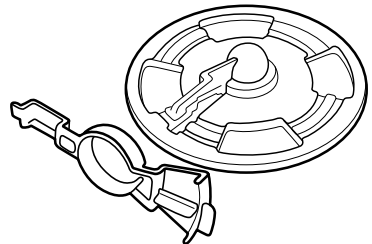
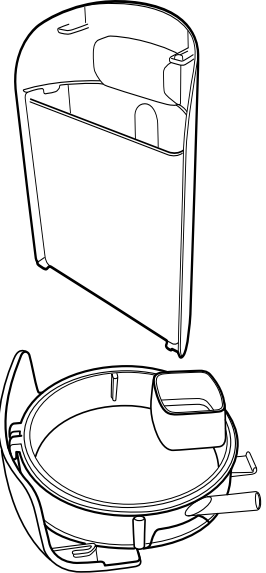

PROBLEM	POSSIBLE CAUSE
I plugged in my formula maker and it won't let press some of the buttons.	If this is the first time using the powder maker, follow the directions in the "First Use" section.
	If you have recently plugged in the formula maker (even if it isn't your first time using it), go through the steps in the "First Use" section of this document.
	If the "Refill Tank" or "Clean Funnel" indicators are lit, you must take care of those issues before dispensing formula.
	If making several bottles at a time, the machine may need a few moments to heat the water before dispensing.

***Do not use a lower concentration setting to save formula. Using a setting that is too low can cause health issues.***

My unit is not releasing enough formula.	Please ensure that you are following the instructions under cleaning and maintenance.
	Ensure that your concentration setting is correct.
	Make sure that the powder bin is more than ¼ full. A powder bin that is too full or too empty can interfere with proper powder dispensing.
	You may try using a different formula, as some may not be compatible with this product. This product was designed to work with the most common brands of baby formula.
	If these steps do not solve this problem, discontinue use and contact customer service.
My unit is releasing too much formula.	Please ensure that you are following the instructions under cleaning and maintenance.
	Ensure that your concentration setting is correct.
	Make sure that the powder bin is not filled beyond the maximum amount indicated in the powder bin. A powder bin that is too full or too empty can interfere with proper powder dispensing.
	You may try using a different formula, as some may not be compatible with this product.
	If these steps do not solve this problem, discontinue use and contact customer service.
Globs of formula are falling into the funnel and causing mixing issues.	Please follow the recommended cleaning instructions. Formula buildup can cause improper powder dispensing. Also, always keep the powder bin covered for humidity protection.

## Tips

- If you ever want to stop dispensing formula, you can press the pause/play button again during formula release to halt the cycle.
- Please ensure that the unit is being properly cleaned.
- The “Refill Water” indicator will activate if there isn’t enough water in the tank.
- The “Clean Funnel” indicator will remind you to clean the unit after several uses.

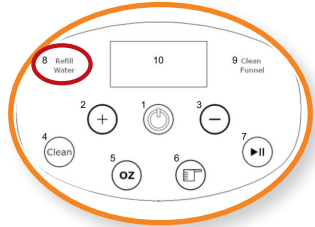
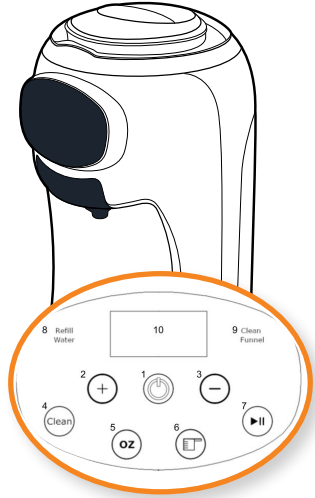



## **WARRANTY & SERVICE**

This Limited Warranty is for one full year from the date of purchase. It is applicable to the original purchaser only and is not transferable to a third party user. Repair or replacement of defective parts is solely at the seller's discretion. In the event that repair isn't possible, the seller will replace the product/part. If product repair/replacement won't suffice, the seller has the option of refunding the cash value of the product or component returned.

Product defects not covered under the Warranty provisions include normal wear and damage incurred from use or accidental negligence, misuse of instruction specifications or repair by unauthorized parties. The manufacturing company is not liable for any incidental or consequential damages incurred by such circumstances.

**FOR CUSTOMER SERVICE  
QUESTIONS OR COMMENTS  
VISIT US @ GOURMIA.COM  
INFO@GOURMIA.COM  
OR CALL 888.552.0033**

**gourmia®**